

Science Together

Azura

## Mounting brackets for AZURA® L devices Supplement



\* Exemplary representation

Document no. V6806



**Note:** Please read the corresponding technical documentation for handling and safety reasons.

### Technical Support:

Phone: +49 30 809727-111 (9-17h, Central European Time)  
Fax: +49 30 8015010  
E-Mail: [support@knauer.net](mailto:support@knauer.net)  
Languages: German, English

### Publisher:

KNAUER Wissenschaftliche Geräte GmbH  
Hegauer Weg 38  
D-14163 Berlin  
Phone: +49 30 809727-0  
Fax: +49 30 8015010  
Internet: [www.knauer.net](http://www.knauer.net)  
E-Mail: [info@knauer.net](mailto:info@knauer.net)



### Version information:

Article number: V6806  
Version number: 6.3  
Last update: 2019/10/07

The information in this document is subject to change without prior notice.  
For latest version of the document, check our website: [www.knauer.net/library](http://www.knauer.net/library)

For the printed version of our instructions, we use environmentally friendly paper from sustainable forests.

### Copyright:

© KNAUER Wissenschaftliche Geräte GmbH 2019. All rights reserved.  
AZURA® is a registered trademark of KNAUER Wissenschaftliche Geräte GmbH.

---

# Table of contents

<b>1. Product information .....</b>	<b>1</b>
<b>2. Attaching a mounting bracket to side panel .....</b>	<b>2</b>
2.1 Manual injection valve V 2.1 .....	3
2.2 Manual injection valve V 4.1 .....	4
2.3 VICI valve drive .....	6
2.4 Flow cell .....	8
2.5 Preparative HPLC column with 20 mm ID .....	9
2.6 Pulsation damper .....	10
2.7 HyperShear mixing chamber .....	12
2.8 Preparative sample loop .....	13
<b>3. Attaching mounting bracket A9854-3 to side panel .....</b>	<b>14</b>
3.1 AZURA® Valve Unifier VU 4.1 .....	14
3.2 AZURA® Conductivity Monitor CM 2.1S .....	17
3.3 AZURA® Detector UVD 2.1S .....	20
<b>4. Repeat orders .....</b>	<b>23</b>

# 1. Product information

A mounting bracket can be installed on the side of the device to attach additional accessories.

The following accessories can be mounted onto the side panel:

Accessories	Comment
KNAUER flow cells	Mounted onto the mounting bracket using an adapter plate
Preparative HPLC column with 20 mm ID	Mounted onto the mounting bracket using a holder
Pulsation damper	Mounted onto the mounting bracket using a holder and adhesive strip
Preparative sample loops 10 ml and 40 ml	Mounted onto the mounting bracket using an adapter
HyperShear mixing chamber	Mounted onto the mounting bracket using holders 1 and 2
Manual KNAUER injection valve AZURA® Valve Unifier VU 4.1 VICI valve drive	Mounted directly onto the mounting bracket A9854-3 at left or right side of the AZURA® L device
AZURA® Conductivity Monitor CM 2.1S	Mounted directly onto the mounting bracket A9854-3 at left side of the AZURA® L device
AZURA® Detector UVD 2.1S	

## 2. Attaching a mounting bracket to side panel

**Note:** For mounting an AZURA® UVD 2.1S, AZURA® VU 4.1 or AZURA® CM 2.1S, refer to chapter 3.

**Tool:** Allen wrench, size 2.5 mm

**Note:** If the screws cannot be turned, align the bore holes of the side panel with the holes of the housing.

### Process

1. Remove the screws on the rear side of the device.
2. Align the side panel and re-tighten the screws.
3. Align the mounting bracket with the bore holes ① in the side panel.

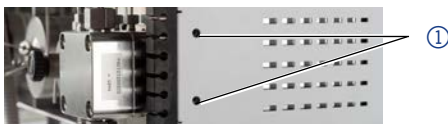

Fig. 1 Bore holes

4. Tighten the 2 screws ②.

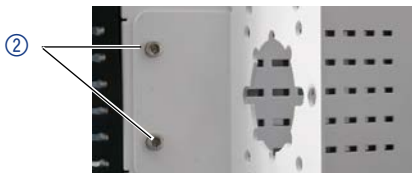

Fig. 2 Screws of mounting bracket

**Next step:** Mount accessories to the mounting bracket.

## 2.1 Manual injection valve V 2.1

**Mounting bracket:** A9853

**Tool:** Allen wrench, size 3 mm

**Prerequisite:** The mounting bracket is attached to the side panel.

### Process

1. Position the valve on the front side of the mounting bracket ①.

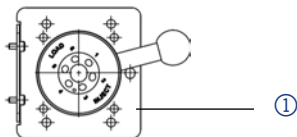

**Fig. 3** Front view

2. Fasten the valve with two screws and two washers ② from the rear side.

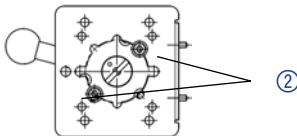

**Fig. 4** Rear view

## 2.2 Manual injection valve V 4.1

**Mounting bracket:** A9853

**Tools:**

- Allen wrench, size 2.5 mm
- Allen wrench, size 3 mm

**Prerequisite:** The mounting bracket is attached to the side panel.

### Process

1. Remove the lid from the lever.
2. Unscrew the screw of the lever ① with the screwdriver 2,5 mm.
3. Pull off the lever from the adapter plate ② .
4. Unscrew the 2 screws of the adapter plate ② with the screwdriver 3 mm.
5. Detach the adapter plate ② from the feather key ③ .
6. Detach feather key ③ from valve head ④ .

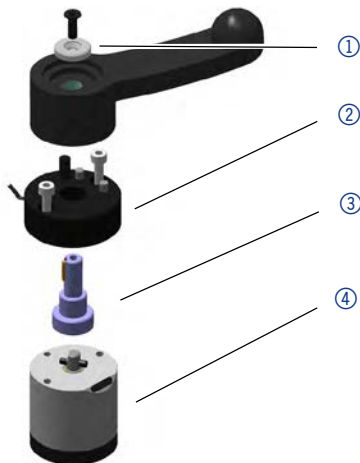

**Fig. 5** Exploded view

## Process

7. Hold valve head frontally onto the mounting bracket so that the mark ⑤ points up and the groove ⑥ points left (see Fig. 13).

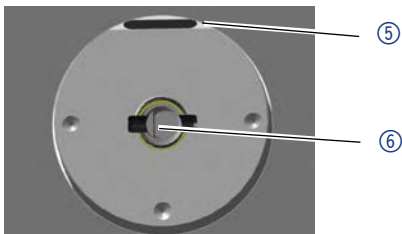

**Fig. 6** Rear view valve

8. Mount the feather key ⑦ pointing to the AZURA® L system onto the groove ⑥ (see Fig. 13).

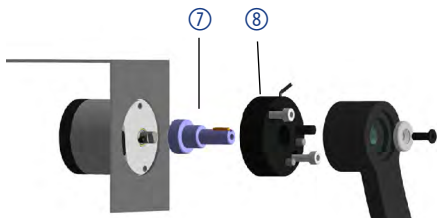

**Fig. 7** Mounting valve

9. Mount the adapter plate ⑧ with the cable pointing down onto the feather key ⑦ and tighten it with the screwdriver 3 mm.
10. Tighten the lever with the screwdriver 2,5 mm and mount the lid onto the lever.



**Note:** In open position, the 6-port valve is connected: port 1 with port 6, port 2 with port 3 and port 4 with port 5.



## 2.3 VICI valve drive

**Mounting bracket:** A9853-2

**Tool:** Allen screwdriver, size 9/64"

**Prerequisite:** The mounting bracket is attached to the side panel.

### Process

1. Screw out the foot of the valve drive with the screwdriver 9/64". Put aside the foot and re-use the screws in step 3.
2. From the rear side, slide the valve drive ① through the opening of the mounting bracket to the front.



**Note:** Therefore, the screw of the stator of the valve must be lead through one of the bulges of the mounting bracket.

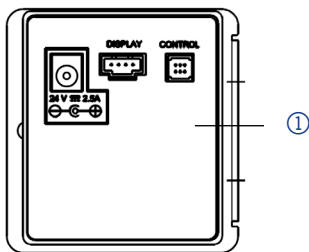

**Fig. 8** VICI valve drive on the mounting bracket rear view

**Process**

3. Tighten the 4 screws ② on the front side.

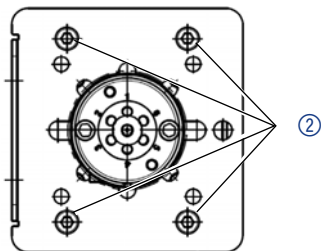

**Fig. 9** VICI valve drive on the mounting bracket front view

---

- Next steps:**
- Store the foot in a dry place.
  - Connect the capillaries.
  - Put the device into operation.

## 2.4 Flow cell

**Mounting bracket:** A9853-5

**Tool:** -

**Prerequisite:** The mounting bracket is attached to the side panel.

### Process

1. Position the adapter plate on the rear side of the mounting bracket.
2. Position the flow cell on the front side of the mounting bracket.
3. Fasten the flow cell with both knurled-head screws ① in position.

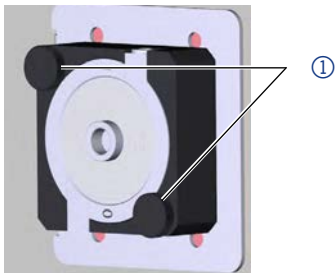

**Fig. 10** Flow cell with adapter plate on the mounting bracket

**Next steps:**

- Connect the capillaries.
- Put the device into operation.

## 2.5 Preparative HPLC column with 20 mm ID

**Mounting bracket:** A9853-3

**Tool:** Allen wrench, size 4 mm

**Prerequisite:** The mounting bracket is attached to the side panel.

### Process

1. Place the column into the holder ①.
2. Align the holder with the bore holes in the mounting bracket.
3. Tighten the screws ② and washers.

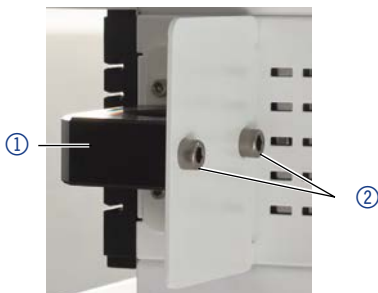

**Fig. 11** Column holder with mounting bracket

- Next steps:**
- Connect the capillaries.
  - Put the device into operation.

## 2.6 Pulsation damper

**Mounting bracket:** FZZ2

**Tool:** Allen wrench, size 4 mm

**Prerequisite:** The mounting bracket is attached to the left side panel of the pump.

### Process

1. Place the provided strip with adhesive side into the holder ① .
2. Place the pulsation damper into the holder.
3. Align the holder with the bore holes in the mounting bracket.

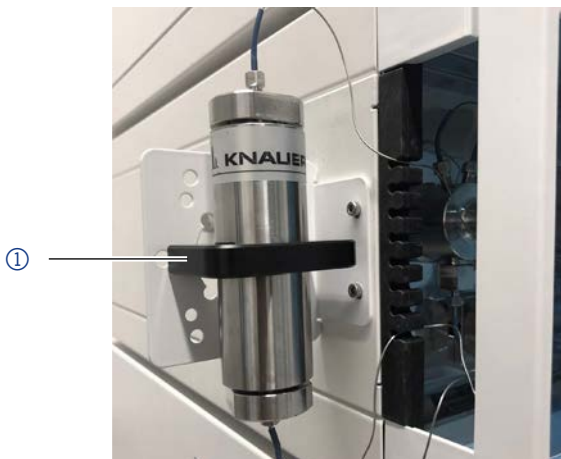

**Fig. 12** Pulsation damper with mounting bracket, front view

**Process**

4. Tighten the screws ② and washers.

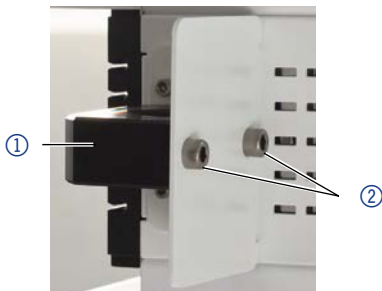

**Fig. 13** Mounting bracket, rear view

---

- Next steps:**
- Connect the capillaries.
  - Put the device into operation.

## 2.7 HyperShear mixing chamber

**Mounting bracket:** A9853-8

**Tool:** Allen wrench, size 2.5 mm

**Prerequisite:** The mounting bracket is attached to the side panel.

### Process and figure

1. Mount the holder ① to the mounting bracket with two screws.



**Fig. 14** Holder at the mounting bracket

2. Screw tight the HyperShear mixing chamber ① and the holder ② onto the mounting bracket.

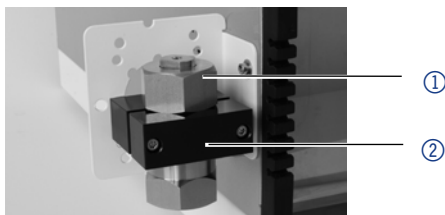

**Fig. 15** Fully mounted HyperShear mixing chamber

## 2.8 Preparative sample loop

**Mounting bracket:** A9853-3

**Tool:** Allen wrench, size 4 mm

**Prerequisite:** The mounting bracket is attached to the side panel.

### Process and figure

1. Place the sample loop ① in the holder ②.
2. Screw tight the holder and sample loop onto the mounting bracket.



**Fig. 16** Fully mounted sample loop front view

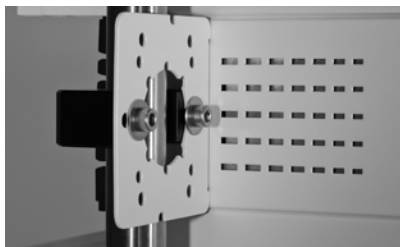

**Fig. 17** Fully mounted sample loop rear view



### 3. Attaching mounting bracket A9854-3 to side panel

#### 3.1 AZURA® Valve Unifier VU 4.1

Tool: Torx key, size TX10

##### Process

1. Remove the screws on the left or right side panel.



Fig. 18 VU 4.1 removing screws

2. Align the mounting bracket with the bore holes of the device and screw it tight with the provided torx screws. Use the outer bore holes on the mounting bracket.

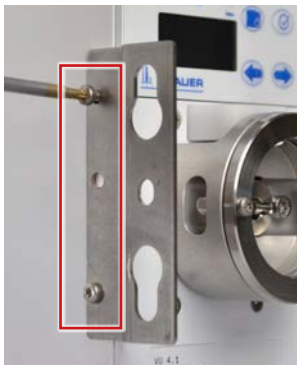
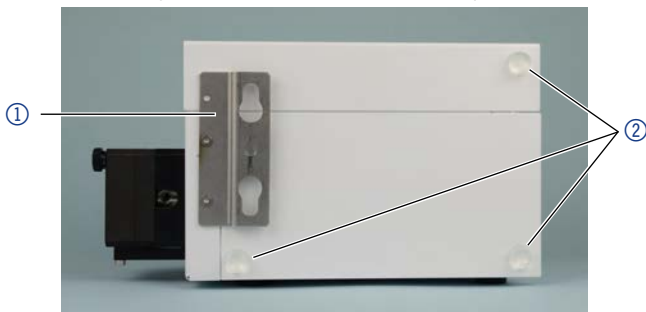

Fig. 19 VU 4.1 & mounting bracket

**Process**

3. Attach the three rubber spacer in the corners of the VU 4.1 on the mounting bracket side as indicated in the picture.



**Fig. 20** AZURA® small device with mounting bracket ① and rubber spacers ② (exemplary picture with UVD 2.1S)

4. Align the guidance clamp with the bore holes of the required side panel of the AZURA® L device and screw it tight with the provided torx screws. Make sure that the upper screw is installed together with the washer.



**Fig. 21** Guidance clamp on AZURA® L device

## Process

- Put the upper keyhole of the mounting bracket onto the washer at the AZURA® L device (Fig. 22) and slide down the valve drive until the middle hole locks with the lower screw of the guidance clamp (Fig. 23).



Fig. 22 Put keyhole on washer



Fig. 23 Lock with lower screw

- Next steps:**
- Connect the capillaries.
  - Put the device into operation.



**Note:** The mounting of a small device to an AZURA® L device with a mounting bracket does not affect the performance of either device. The space requirements specified in the related instructions do not apply in this case.

## 3.2 AZURA® Conductivity Monitor CM 2.1S

Tool: Torx key, size TX10

### Process

1. Use the bore holes on the right side panel. No screws have to be removed.



Fig. 24 CM 2.1S bore holes

2. Align the mounting bracket with the bore holes of the device and screw it tight with the provided torx screws. Use the upper and middle bore hole on the mounting bracket.



Fig. 25 CM 2.1S & mount. bracket

## Process

3. Attach the three rubber spacer in the corners of the CM 2.1S on the mounting bracket side as indicated in the picture.

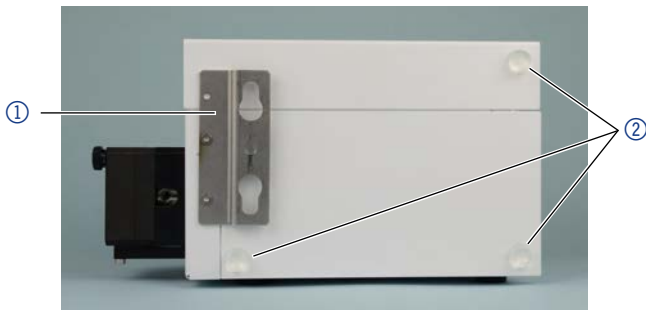

**Fig. 26** AZURA® small device with mounting bracket ① and rubber spacers ② (exemplary picture with UVD 2.1S)

4. Align the guidance clamp with the bore holes of the required side panel of the AZURA® L device and screw it tight with the provided torx screws. Make sure that the upper screw is installed together with the washer.



**Fig. 27** Guidance clamp on AZURA® L device

5. Put the upper keyhole of the mounting bracket onto the washer at the AZURA® L device (Fig. 28) and slide down the valve drive until the middle hole locks with the lower screw of the guidance clamp (Fig. 29).

**Process**

**Fig. 28** Put keyhole on washer (exemplary picture with VU 4.1)



**Fig. 29** Lock with lower screw (exemplary picture with VU 4.1)

- Next steps:**
- Connect the capillaries.
  - Put the device into operation.



**Note:** The mounting of a small device to an AZURA® L device with a mounting bracket does not affect the performance of either device. The space requirements specified in the related instructions do not apply in this case.

### 3.3 AZURA® Detector UVD 2.1S

Tool: Torx key, size TX10

#### Process

1. Use the bore holes on the right side panel. No screws have to be removed.



Fig. 30 UVD 2.1S bore holes

2. Turn the bracket with the bigger holes pointing inward and use the lower bore holes to attach the mounting bracket on the detector.



Fig. 31 UVD 2.1S & mount. bracket

**Process**

3. Attach the three rubber spacer in the corners of the UVD 2.1S on the mounting bracket side as indicated in the picture.

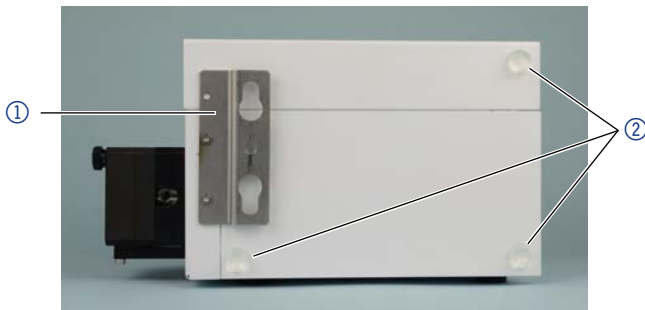

**Fig. 32** AZURA® UVD 2.1S with mounting bracket ① and rubber spacers ②

4. Align the guidance clamp with the bore holes of the required side panel of the AZURA® L device and screw it tight with the provided torx screws. Make sure that the upper screw is installed together with the washer.



**Fig. 33** Guidance clamp on AZURA® L device



## Process

- Put the upper keyhole of the mounting bracket onto the washer at the AZURA® L device (Fig. 34) and slide down the valve drive until the middle hole locks with the lower screw of the guidance clamp (Fig. 35).



Fig. 34 Put keyhole on washer

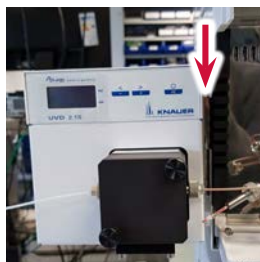

Fig. 35 Lock with lower screw

- Next steps:**
- Connect the capillaries.
  - Put the device into operation.



**Note:** The mounting of a small device to an AZURA® L device with a mounting bracket does not affect the performance of either device. The space requirements specified in the related instructions do not apply in this case.

## 4. Repeat orders

Mounting brackets for AZURA® L devices

<b>Mounting components</b>	<b>Article no.</b>
Manual KNAUER injection valves V 2.1 and V4.1	A9853
VICI valve drive	A9853-2
Preparative HPLC column with 20 mm ID	A9853-3
Pulsation damper	FZZ2
KNAUER flow cells	A9853-5
Preparative sample loops 10 ml and 40 ml	A9853-6
HyperShear mixing chamber	A9853-8
AZURA® Valve Unifier VU 4.1	A9854-3
AZURA® Conductivity Monitor CM 2.1S	A9854-3
AZURA® Detector UVD 2.1S	A9854-3

Science Together



Latest KNAUER instructions online:  
[www.knauer.net/library](http://www.knauer.net/library)

© KNAUER 2019

**KNAUER**  
Wissenschaftliche Geräte GmbH  
Hegauer Weg 38  
14163 Berlin

Phone: +49 30 809727-0  
Fax: +49 30 8015010  
E-Mail: [info@knauer.net](mailto:info@knauer.net)  
Internet: [www.knauer.net](http://www.knauer.net)